

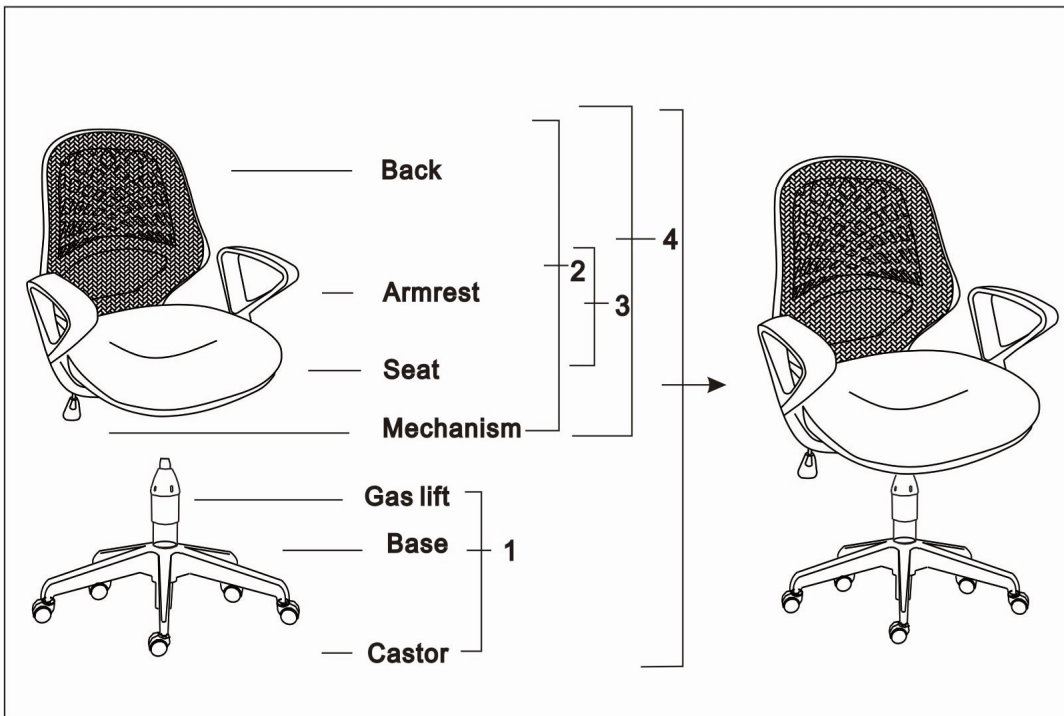

# ASSEMBLY INSTRUCTIONS

"functional seating for today's workplace"

MODEL:BCM/K116

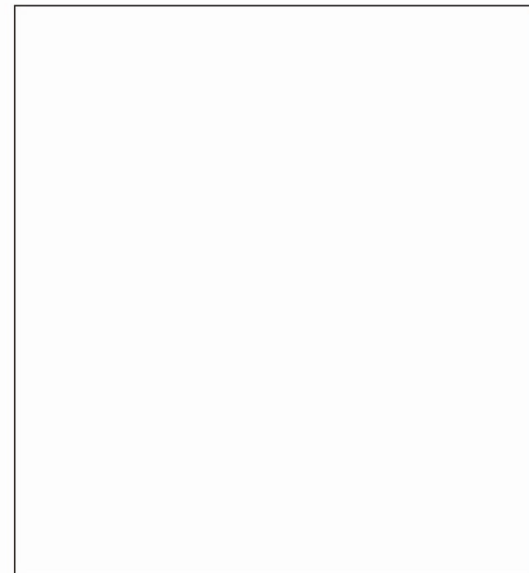
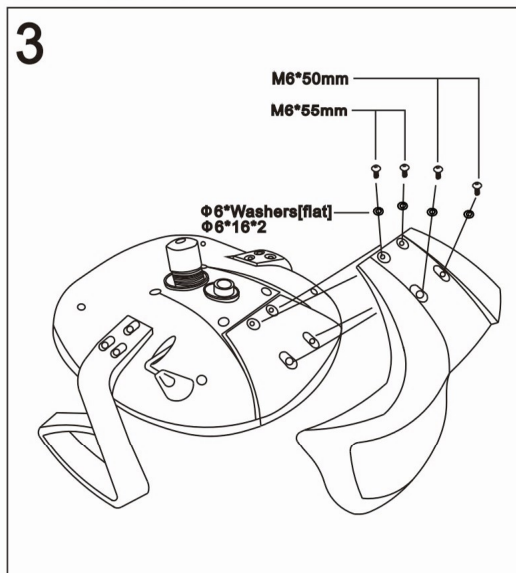
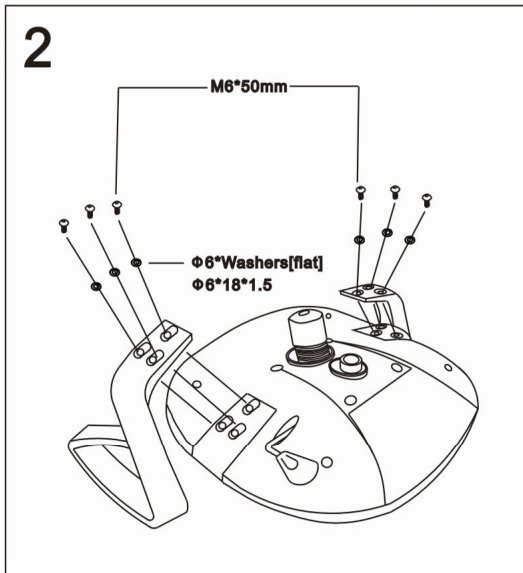
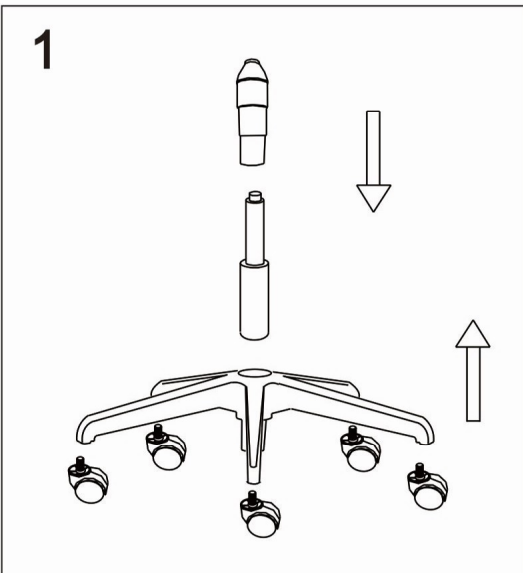

|         |   |           |      |
|---------|---|-----------|------|
|         |   |           | Flat |
| M6*50mm | 8 | φ6*18*1.5 |      |
| M6*55mm | 2 | 6         |      |
|         |   | φ6*16*2   |      |
|         |   | 4         |      |

Use the ruler to help identify parts

**Parts Checklist**

## PREVENTIVE MAINTENANCE AND WARNING

- ONLY FOR SEATING ONE PERSON AT A TIME.
- DO NOT USE CHAIR AS STEP STOOL OR LADDER.
- WHEN INSTALLING SPRING HANDWHEEL, PLS PUT STEEL BOWL WASHER'S SMALL ROUND MOUTH AS DIRECTIONS AT THE SPRING
- DO NOT USE CHAIR UNLESS ALL BOLTS,SCREWS ARE TIGHT.
- AT LEAST EVERY SIX MONTHS CHECK ALL BOLTS AND SCREWS TO BESURE THEY ARE TIGHT.
- IF ANY PARTS ARE MISSING,BROKEN,DAMAGED OR WORN, STOP USING THE PRODUCT UNTIL REPAIRS ARE MADE WITH FACTORY AUTHORIZED PARTS.
- FAILURE TO FOLLOW THESE WARNINGS CAN RESULT IN SERIOUS INJURY.